

SGP | In wall manifold box



Material:	Steel sheet
Corrosion protection:	Degreasing Zirconium surface Powder coating
Color:	White [01]
Warranty:	2 years
Purpose:	For installing heating manifolds in the central heating system

KEY FEATURES:

- Galvanized cabinet body - joined without welding.
- Body made of one sheet of metal.
- Galvanized mounting rails for manifolds with screws and nuts.
- Coin-operated lock
- The SGP 6 box is equipped with two locks.
- The frame and door of the cabinet are entirely powder coated.
- Easy, clean manifold assembly.
- Wide access to the manifold during installation.
- Less chance of damaging the cabinet frame and door, thanks to the possibility of removing the frame with the door.

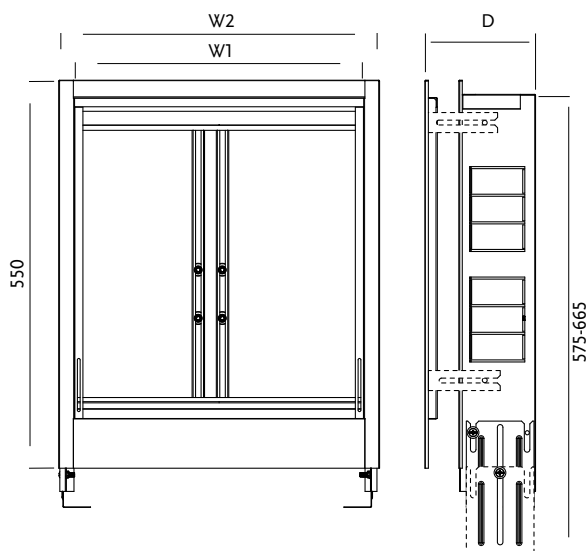

SGP - 6

Type	Width [W1] mm	Width [W2] mm	Height [H] mm	Depth [D] mm	Index
SGP - 0	335	380	575-665	110-175	1041112110
SGP - 1	435	480	575-665	110-175	1041112120
SGP - 2	565	610	575-665	110-175	1041112130
SGP - 3	715	760	575-665	110-175	1041112140
SGP - 4	795	840	575-665	110-175	1041112150
SGP - 5	965	1010	575-665	110-175	1041112160
SGP - 6	1130	1175	575-665	110-175	1041112161